



SKN Products, LLC

INDUSTRIAL PRODUCTS — WE WHOLESALING, YOU DISTRIBUTE

K SERIES NYLON INSULATED TERMINALS

**NYLON INSULATED TERMINALS (BRAZED SEAM)
WITH COPPER SLEEVES**

**SINGLE CRIMP NYLON INSULATED TERMINALS
(BRAZED SEAM)**



UL LISTED

4909 Rondo Drive, Fort Worth, Texas 76106, USA

Telephone: 1-817-403-5835

Fax: 1-817-624-3721

Email: sales@sknproductsllc.com

www.sknproducts.com

www.sknproductsllc.com

CATALOG 2023

SELECTION GUIDE OF SKN K SERIES TERMINALS



SELECTION GUIDE OF K SERIES NYLON INSULATED TERMINALS WITH COPPER SLEEVES

Product Numbers of SKN K Series Nylon Insulated Ring Terminals (Braze Seam) with Copper Sleeves

Insulation Color	Wire Range	Stud Size						
		#6	#8	#10	1/4"	5/16"	3/8"	1/2"
Red	22-18	KR6A6	KR6A8	KR6A10	KR6A14	KR6A56	KR6A38	
Blue	16-14	KR6B6	KR6B8	KR6B10	KR6B14	KR6B56	KR6B38	
Yellow	12-10	KR6C6	KR6C8	KR6C10	KR6C14	KR6C56	KR6C38	KR6C12

Product Numbers of SKN K Series Nylon Insulated Spade Terminals (Braze Seam) with Copper Sleeves

Insulation Color	Wire Range	Stud Size			
		#6	#8	#10	
Red	22-18	KS6A6S	KS6A8S	KS6A10	KS6A10S
Blue	16-14	KS6B6S	KS6B8S	KS6B10	KS6B10S
Yellow	12-10	KS6C6	KS6C8	KS6C10	

Product Numbers of SKN K Series Nylon Insulated Locking Spade Terminals (Braze Seam) with Copper Sleeves

Insulation Color	Wire Range	Stud Size			
		#6	#8	#10	1/4"
Red	22-18	KTLS6A6	KTLS6A8	KTLS6A10	
Blue	16-14	KTLS6B6	KTLS6B8	KTLS6B10	
Yellow	12-10	KTLS6C6	KTLS6C8	KTLS6C10	KTLS6C14

SELECTION GUIDE OF SINGLE CRIMP NYLON INSULATED TERMINALS

Product Numbers of SKN K Series Single Crimp Nylon Insulated Ring Terminals (Braze Seam)

Insulation Color	Wire Range	Stud Size						
		#6	#8	#10	1/4"	5/16"	3/8"	1/2"
Red	22-18	KR8A6	KR8A8	KR8A10	KR8A14	KR8A56	KR8A38	
Blue	16-14	KR8B6	KR8B8	KR8B10	KR8B14	KR8B56	KR8B38	
Yellow	12-10	KR8C6	KR8C8	KR8C10	KR8C14	KR8C56	KR8C38	KR8C12
Red	8			KR8E10	KR8E14	KR8E56	KR8E38	KR8E12
Blue	6			KR8F10	KR8F14	KR8F56	KR8F38	KR8F12
Yellow	4			KR8G10	KR8G14	KR8G56	KR8G38	KR8G12

Product Numbers of SKN K Series Single Crimp Nylon Insulated Spade Terminals (Braze Seam)

Insulation Color	Wire Range	Stud Size			
		#6	#8	#10	
Red	22-18	KS8A6S	KS8A8S	KS8A10	KS8A10S
Blue	16-14	KS8B6S	KS8B8S	KS8B10	KS8B10S
Yellow	12-10	KS8C6	KS8C8	KS8C10	

Product Numbers of SKN K Series Single Crimp Nylon Insulated Locking Spade Terminals (Braze Seam)

Insulation Color	Wire Range	Stud Size			
		#6	#8	#10	1/4"
Red	22-18	KTLS8A6	KTLS8A8	KTLS8A10	
Blue	16-14	KTLS8B6	KTLS8B8	KTLS8B10	
Yellow	12-10	KTLS8C6	KTLS8C8	KTLS8C10	KTLS8C14

FEATURES OF K SERIES NYLON INSULATED TERMINALS (BRAZED SEAM) WITH COPPER SLEEVES

- UL listed
- Nylon insulated
- Manufactured from one piece high conductivity electrolytic copper
- Electro tin plated for copper parts
- Seamless high conductivity copper sleeves securely attached to terminal barrel
- Brazed seam
- Ease of wire insertion with beveled mouth entry and funnel barrel construction
- Non-slip ridge for correct tool position when crimping
- Wire range indicated by industry standard color coding
- Maximum temperature 221°F (105°C)
- Maximum voltage 600V



For Copper Wire only

FEATURES OF K SERIES SINGLE CRIMP NYLON INSULATED TERMINALS (BRAZED SEAM)

- UL listed
- Nylon insulated
- Manufactured from one piece high conductivity electrolytic copper
- Electro tin plated for copper parts
- Brazed seam
- Ease of wire insertion with beveled mouth entry and funnel barrel construction
- Non-slip ridge for correct tool position when crimping
- Wire range indicated by industry standard color coding
- Maximum temperature 221°F (105°C)
- Maximum voltage 600V



For Copper Wire only

SPECIFICATIONS OF K SERIES NYLON INSULATED RING TERMINALS (BRAZED SEAM) WITH COPPER SLEEVES

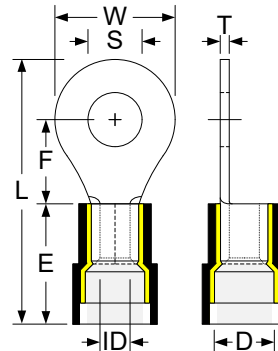

- All K Series nylon insulated terminals are UL listed.
- All copper parts are tin plated.
- All nylon insulated terminals are with brazed seam and copper sleeves.
- Maximum temperature is 221°F (105°C).
- Maximum voltage is 600V.



Product Number	Nylon Color	Wire Range (AWG)	Stud Size	Stud	Length		Width	Barrel Length	Nylon Barrel	Barrel I.D.	Copper Thickness	Strip Length
				S	L	F	W	E	D	ID	T	
KR6A6	Red	22-18	#6	0.146"	0.803"	0.248"	0.260"	0.433"	0.177"	0.067"	0.030"	0.189"
KR6A8			#8	0.169"	0.858"	0.276"	0.315"					
KR6A10			#10	0.200"			0.457"					
KR6A14			1/4"	0.252"	1.094"	0.433"	0.551"					
KR6A56			5/16"	0.328"								
KR6A38			3/8"	0.390"	1.240"	0.549"	0.630"					
KR6B6	Blue	16-14	#6	0.146"	0.803"	0.248"	0.260"	0.433"	0.205"	0.091"	0.031"	0.189"
KR6B8			#8	0.169"	0.898"	0.307"	0.335"					
KR6B10			#10	0.209"			0.374"					
KR6B14			1/4"	0.252"	1.094"	0.433"	0.472"					
KR6B56			5/16"	0.328"			0.551"					
KR6B38			3/8"	0.390"	1.240"	0.547"	0.630"					
KR6C6	Yellow	12-10	#6	0.146"	0.894"	0.240"	0.283"	0.512"	0.276"	0.134"	0.039"	0.236"
KR6C8			#8	0.169"	1.024"	0.328"	0.374"					
KR6C10			#10	0.209"								
KR6C14			1/4"	0.252"	1.161"	0.413"	0.472"					
KR6C56			5/16"	0.331"	1.339"	0.524"	0.591"					
KR6C38			3/8"	0.390"								
KR6C12			1/2"	0.512"	1.520"	0.630"	0.756"					

** All dimensions in inches*

SPECIFICATIONS OF K SERIES NYLON INSULATED SPADE TERMINALS (BRAZED SEAM) WITH COPPER SLEEVES

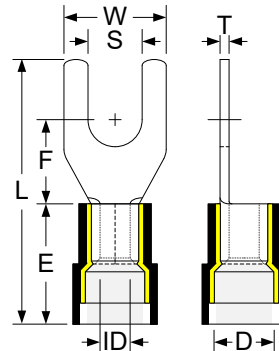

- All K Series nylon insulated terminals are UL listed.
- All copper parts are tin plated.
- All nylon insulated terminals are with brazed seam and copper sleeves.
- Maximum temperature is 221°F (105°C).
- Maximum voltage is 600V.



Product Number	Nylon Color	Wire Range (AWG)	Stud Size	Stud	Length	F	Width	Barrel Length	Nylon Barrel	Barrel I.D.	Copper Thickness	Strip Length
				S			L					
KS6A6S	Red	22-18	#6	0.146"	0.866"	0.256"	0.252"	0.433"	0.177"	0.067"	0.030"	0.189"
KS6A8S			#8	0.169"			0.283"					
KS6A10S			#10	0.209"			0.319"					
KS6A10							0.374"					
KS6B6S	Blue	16-14	#6	0.146"	0.866"	0.256"	0.225"	0.433"	0.205"	0.091"	0.031"	0.189"
KS6B8S			#8	0.169"			0.245"					
KS6B10S			#10	0.209"			0.319"					
KS6B10							0.366"					
KS6C6	Yellow	12-10	#6	0.146"	1.004"	0.276"	0.327"	0.512"	0.276"	0.134"	0.039"	0.236"
KS6C8			#8	0.169"			0.327"					
KS6C10			#10	0.209"			0.354"					

* All dimensions in inches

SPECIFICATIONS OF K SERIES NYLON INSULATED LOCKING SPADE TERMINALS (BRAZED SEAM) WITH COPPER SLEEVES

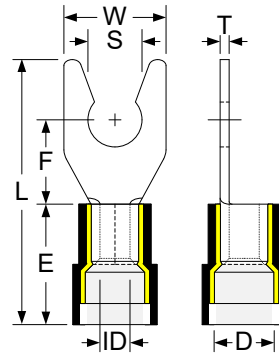

- All K Series nylon insulated terminals are UL listed.
- All copper parts are tin plated.
- All nylon insulated terminals are with brazed seam and copper sleeves.
- Maximum temperature is 221°F (105°C).
- Maximum voltage is 600V.



Product Number	Nylon Color	Wire Range (AWG)	Stud Size	Stud	Length	F	Width	Barrel Length	Nylon Barrel	Barrel I.D.	Copper Thickness	Strip Length
				S			L					
KTLS6A6	Red	22-18	#6	0.146"	0.866"	0.256"	0.252"	0.433"	0.177"	0.067"	0.030"	0.189"
KTLS6A8			#8	0.169"			0.319"					
KTLS6A10			#10	0.209"			0.319"					
KTLS6B6	Blue	16-14	#6	0.146"	0.866"	0.256"	0.236"	0.433"	0.205"	0.091"	0.031"	0.189"
KTLS6B8			#8	0.169"			0.319"					
KTLS6B10			#10	0.209"			0.319"					
KTLS6C6	Yellow	12-10	#6	0.146"	0.992"	0.276"	0.327"	0.512"	0.276"	0.134"	0.039"	0.236"
KTLS6C8			#8	0.169"			0.354"					
KTLS6C10			#10	0.209"			0.354"					
KTLS6C14			#14	0.252"			1.240"					

** All dimensions in inches*

SPECIFICATIONS OF K SERIES SINGLE CRIMP NYLON INSULATED RING TERMINALS (BRAZED SEAM)

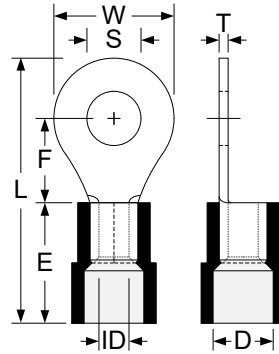

- All K Series nylon insulated terminals are UL listed.
- All copper parts are tin plated.
- All nylon insulated terminals are with brazed seam
- Maximum temperature is 221°F (105°C).
- Maximum voltage is 600V.



Product Number	Nylon Color	Wire Range (AWG)	Stud Size	Stud	Length		Width	Barrel Length	Nylon Barrel	Barrel I.D.	Copper Thickness	Strip Length
				S	L	F	W	E	D	ID	T	
KR8A6	Red	22-18	#6	0.146"	0.803"	0.248"	0.260"	0.433"	0.157"	0.067"	0.030"	0.189"
KR8A8			#8	0.169"	0.858"	0.276"	0.315"					
KR8A10			#10	0.209"	1.094"	0.433"	0.457"					
KR8A14			1/4"	0.252"	1.240"	0.547"	0.535"					
KR8A56			5/16"	0.331"	1.240"	0.547"	0.535"					
KR8A38			3/8"	0.413"	1.240"	0.547"	0.535"					
KR8B6	Blue	16-14	#6	0.146"	0.803"	0.248"	0.260"	0.433"	0.177"	0.091"	0.031"	0.189"
KR8B8			#8	0.169"	0.898"	0.307"	0.335"					
KR8B10			#10	0.209"	1.094"	0.433"	0.472"					
KR8B14			1/4"	0.252"	1.240"	0.547"	0.535"					
KR8B56			5/16"	0.331"	1.240"	0.547"	0.535"					
KR8B38			3/8"	0.413"	1.240"	0.547"	0.535"					
KR8C6	Yellow	12-10	#6	0.146"	0.894"	0.240"	0.283"	0.512"	0.252"	0.134"	0.039"	0.236"
KR8C8			#8	0.169"	1.024"	0.327"	0.374"					
KR8C10			#10	0.209"	1.161"	0.413"	0.472"					
KR8C14			1/4"	0.252"	1.339"	0.524"	0.591"					
KR8C56			5/16"	0.331"	1.520"	0.630"	0.756"					
KR8C38			3/8"	0.413"	1.520"	0.630"	0.756"					
KR8C12			1/2"	0.512"	1.520"	0.630"	0.756"					

* All dimensions in inches

SPECIFICATIONS OF K SERIES SINGLE CRIMP NYLON INSULATED RING TERMINALS (BRAZED SEAM)

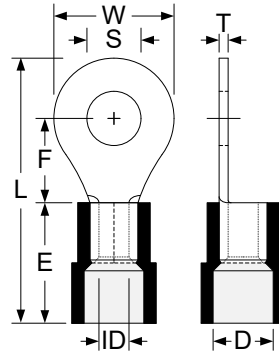

- All K Series nylon insulated terminals are UL listed.
- All copper parts are tin plated.
- All nylon insulated terminals are with brazed seam
- Maximum temperature is 221°F (105°C).
- Maximum voltage is 600V.



Product Number	Nylon Color	Wire Range (AWG)	Stud Size	Stud	Length		Width	Barrel Length	Nylon Barrel	Barrel I.D.	Copper Thickness	Strip Length
				S	L	F	W	E	D	ID	T	
KR8E10	Red	8	#10	0.209"	1.232"	0.366"	0.472"	0.630"	0.315"	0.177"	0.047"	0.337"
KR8E14			1/4"	0.252"								
KR8E56			5/16"	0.331"	1.469"	0.543"	0.591"					
KR8E38			3/8"	0.413"								
KR8E12			1/2"	0.512"								
KR8F10	Blue	6	#10	0.209	1.606"	0.524"	0.472"	0.846"	0.433"	0.228"	0.059"	0.413"
KR8F14			1/4"	0.252								
KR8F56			5/16"	0.331	1.713"	0.559"	0.630"					
KR8F38			3/8"	0.413								
KR8F12			1/2"	0.512								
KR8G10	Yellow	4	#10	0.209"	1.780"	0.614"	0.480"	0.945"	0.512"	0.303"	0.670"	0.472"
KR8G14			1/4"	0.252"								
KR8G56			5/16"	0.331"	1.791"	0.531"	0.650"					
KR8G38			3/8"	0.413"								
KR8G12			1/2"	0.512"								

* All dimensions in inches

**SPECIFICATIONS OF K SERIES SINGLE CRIMP
NYLON INSULATED SPADE TERMINALS (BRAZED SEAM)**

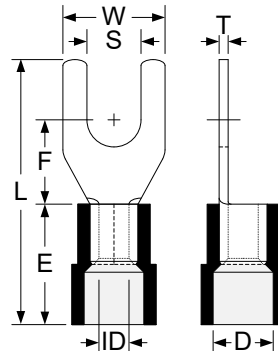

- All K Series nylon insulated terminals are UL listed.
- All copper parts are tin plated.
- All nylon insulated terminals are with brazed seam
- Maximum temperature is 221°F (105°C).
- Maximum voltage is 600V.



Product Number	Nylon Color	Wire Range (AWG)	Stud Size	Stud	Length		Width	Barrel Length	Nylon Barrel	Barrel I.D.	Copper Thickness	Strip Length
				S	L	F	W	E	D	ID	T	
KS8A6S	Red	22-18	#6	0.146"	0.866"	0.256"	0.252"	0.433"	0.157"	0.067"	0.030"	0.189"
KS8A8S			#8	0.169"			0.283"					
KS8A10S			#10	0.209"			0.319"					
KS8A10							0.374"					
KS8B6S	Blue	16-14	#6	0.146"	0.866"	0.256"	0.224"	0.433"	0.177"	0.091"	0.031"	0.189"
KS8B8S			#8	0.169"			0.252"					
KS8B10S			#10	0.209"			0.319"					
KS8B10							0.366"					
KS8C6	Yellow	12-10	#6	0.146"	1.004"	0.276"	0.327"	0.512"	0.252"	0.134"	0.039"	0.236"
KS8C8			#8	0.169"			0.327"					
KS8C10			#10	0.209"			0.354"					

* All dimensions in inches

**SPECIFICATIONS OF K SERIES SINGLE CRIMP
NYLON INSULATED LOCKING SPADE TERMINALS (BRAZED SEAM)**

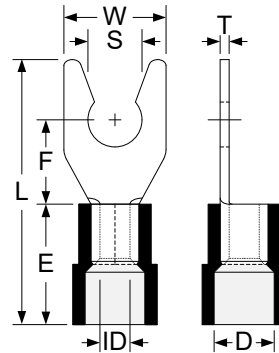

- All K Series nylon insulated terminals are UL listed.
- All copper parts are tin plated.
- All nylon insulated terminals are with brazed seam
- Maximum temperature is 221°F (105°C).
- Maximum voltage is 600V.



Product Number	Nylon Color	Wire Range (AWG)	Stud Size	Stud	Length	F	Width	Barrel Length	Nylon Barrel	Barrel I.D.	Copper Thickness	Strip Length
				S			L					
KTLS8A6	Red	22-18	#6	0.146"	0.866"	0.256"	0.252"	0.433"	0.157"	0.067"	0.030"	0.189"
KTLS8A8			#8	0.169"			0.319"					
KTLS8A10			#10	0.209"			0.319"					
KTLS8B6	Blue	16-14	#6	0.146"	0.866"	0.256"	0.236"	0.433"	0.177"	0.091"	0.031"	0.189"
KTLS8B8			#8	0.169"			0.319"					
KTLS8B10			#10	0.209"			0.366"					
KTLS8C6	Yellow	12-10	#6	0.146"	0.992"	0.276"	0.327"	0.512"	0.252"	0.134"	0.039"	0.236"
KTLS8C8			#8	0.169"			0.327"					
KTLS8C10			#10	0.209"			0.354"					
KTLS8C14			#14	0.252"			1.240"					

** All dimensions in inches*

RECOMMENDED TOOLS OF NYLON INSULATED TERMINALS



Eclipse Luner Series Ratcheted Crimper
Product Number: 300-141



Eclipse Round Cable Cutter
Product Number: 200-046



Eclipse Wire Stripping Tool
Product Number: 200-003

RECOMMENDED TOOLS OF NYLON INSULATED TERMINALS			
ALL K SERIES NYLON INSULATED TERMINALS	Crimp Tool	Wire Cutter	Wire Stripper
	300-141	200-046	200-003



IMPORTANT NOTES FOR PURCHASERS AND USERS

IMPORTANT NOTES FOR PURCHASERS AND USERS

Before using this product, user should determine the suitability of the product for its intended use.

SKN expressly disclaims the implied warranties and conditions of merchantability and fitness for a particular purpose. In no case shall SKN be liable under any legal theory, including but not limited to contract or strict liability, for any direct, indirect, special, incidental, or consequential damages resulting from product use.

Made in China



WARRANTY; LIMITED REMEDY; LIMITED LIABILITY

WARRANTY; LIMITED REMEDY; LIMITED LIABILITY

This product will be free from defects in material and manufacture as the date of purchase. SKN makes no other warranties including, but not limited to, any implied warranty of merchantability or fitness for a particular purpose. If this product is defective within the warranty period stated above, your exclusive remedy shall be, at SKN's option, to replace or repair or refund the purchase price of SKN product. Except where prohibited by Law, SKN will not be liable for any loss or damage arising from SKN product, whether direct, indirect, special, incidental or consequential regardless of the legal theory asserted.