



SKN Products, LLC

INDUSTRIAL PRODUCTS — WE WHOLESALe, YOU DISTRIBUTE

COPPER CABLE LUGS

COPPER CABLE LUGS (SEAMLESS TUBULAR) (TIN PLATED)

COPPER CABLE LUGS (SEAMLESS TUBULAR) (NON-PLATED)



UL LISTED

4909 Rondo Drive, Fort Worth, Texas 76106, USA

Telephone: 1-817-403-5835

Fax: 1-817-624-3721

Email: sales@sknproductsllc.com

www.sknproducts.com

www.sknproductsllc.com

CATALOG

2024



SELECTION GUIDE OF SKN COPPER CABLE LUGS



Copper Cable Lugs
(Seamless Tubular) (Tin Plated)



Copper Cable Lugs
(Seamless Tubular) (Non-plated)

Product Numbers of SKN Copper Cable Lugs (Seamless Tubular) (Tin Plated)

Stud Size Wire Range	#10	1/4"	5/16"	3/8"	1/2"
8	CL810TP	CL814TP	CL856TP	CL838TP	CL812TP
6	CL610TP	CL614TP	CL656TP	CL638TP	CL612TP
4	CL410TP	CL414TP	CL456TP	CL438TP	CL412TP
2		CL214TP	CL256TP	CL238TP	CL212TP
1		CL114TP	CL156TP	CL138TP	CL112TP
1/0		CL1014TP	CL1056TP	CL1038TP	CL1012TP
2/0		CL2014TP	CL2056TP	CL2038TP	CL2012TP
3/0			CL3056TP	CL3038TP	CL3012TP
4/0			CL4056TP	CL4038TP	CL4012TP

Product Numbers of SKN Copper Cable Lugs (Seamless Tubular) (Non-plated)

Stud Size Wire Range	#10	1/4"	5/16"	3/8"	1/2"
8	CL810	CL814	CL856	CL838	CL812
6	CL610	CL614	CL656	CL638	CL612
4	CL410	CL414	CL456	CL438	CL412
2		CL214	CL256	CL238	CL212
1		CL114	CL156	CL138	CL112
1/0		CL1014	CL1056	CL1038	CL1012
2/0		CL2014	CL2056	CL2038	CL2012
3/0			CL3056	CL3038	CL3012
4/0			CL4056	CL4038	CL4012



FEATURES OF COPPER CABLE LUGS (SEAMLESS TUBULAR) (TIN PLATED)

- Electro tin plated
- Manufactured from high conductivity seamless copper tubing
- Ease of wire insertion with flared end
- Industry standard AWG marked on terminals indicating wire range
- Maximum voltage 600V

For Copper Wire only

FEATURES OF COPPER CABLE LUGS (SEAMLESS TUBULAR) (NON-PLATED)

- Manufactured from high conductivity seamless copper tubing
- Ease of wire insertion with flared end
- Industry standard AWG marked on terminals indicating wire range
- Maximum voltage 600V

For Copper Wire only

**SPECIFICATIONS OF COPPER CABLE LUGS
(SEAMLESS TUBULAR) (TIN PLATED)
AWG 8 to AWG 1**

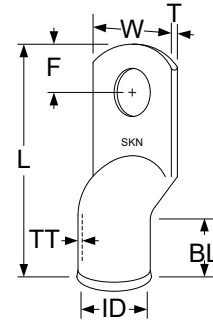

- All copper cable lugs are tin plated.
- Maximum voltage is 600V.

Product Number	Wire Range (AWG)	Stud Size	Stud	Length		Width		Pad Thickness	Tube Thickness	Barrel Length	Barrel I.D.	Pad Length	Strip Length
				L	W	F	T						
CL810TP	8	#10	0.200"	1.100"	0.450"	0.246"	0.048"	0.0354"	0.340"	0.185"	0.624"	0.330"	
CL814TP		1/4"	0.265"	1.200"	0.480"	0.318"	0.049"				0.686"		
CL856TP		5/16"	0.328"	1.230"	0.510"	0.330"	0.045"				0.724"		
CL838TP		3/8"	0.407"	1.366"	0.614"		0.055"	0.0512"	0.433"	0.185"	0.443"		
CL812TP		1/2"	0.512"	1.508"	0.728"		0.051"						
CL610TP	6	#10	0.200"	1.340"	0.540"	0.254"	0.053"	0.0394"	0.420"	0.232"	0.725"	0.410"	
CL614TP		1/4"	0.265"			0.280"	0.052"				0.751"		
CL656TP		5/16"	0.328"	1.370"	0.550"	0.364"	0.047"				0.756"		
CL638TP		3/8"	0.397"	1.380"	0.590"	0.370"	0.047"	0.767"					
CL612TP		1/2"	0.515"	1.550"	0.740"	0.390"	0.035"	0.905"					
CL410TP	4	#10	0.200"	1.350"	0.540"	0.300"	0.066"	0.0314"	0.530"	0.299"	0.654"	0.520"	
CL414TP		1/4"	0.265"	1.380"			0.065"				0.677"		
CL456TP		5/16"	0.328"	1.420"	0.590"	0.350"	0.056"				0.708"		
CL438TP		3/8"	0.397"	1.560"	0.678"	0.419"	0.060"	0.835"					
CL412TP		1/2"	0.515"	1.640"	0.740"	0.406"	0.057"	0.898"					
CL214TP	2	1/4"	0.265"	1.610"	0.626"	0.310"	0.082"	0.0433"	0.550"	0.343"	0.727"	0.540"	
CL256TP		5/16"	0.328"			0.360"	0.086"				0.779"		
CL238TP		3/8"	0.397"	1.720"	0.689"	0.440"	0.068"				0.839"		
CL212TP		1/2"	0.515"	1.770"	0.730"	0.481"	0.063"				0.995"		
CL114TP	1	1/4"	0.265"	1.680"	0.656"	0.401"	0.082"	0.0433"	0.560"	0.360"	0.793"	0.550"	
CL156TP		5/16"	0.328"			0.673"	0.374"				0.083"		0.980"
CL138TP		3/8"	0.397"	1.800"	0.720"	0.421"	0.067"				0.994"		
CL112TP		1/2"	0.515"	1.860"	0.800"	0.485"					0.984"		

* All dimensions in inches

**SPECIFICATIONS OF COPPER CABLE LUGS
(SEAMLESS TUBULAR) (TIN PLATED)
AWG 1/0 to AWG 4/0**

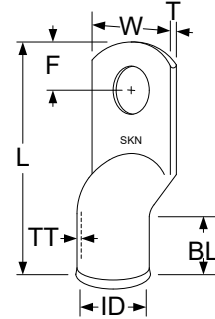

- All copper cable lugs are tin plated.
- Maximum voltage is 600V.

Product Number	Wire Range (AWG)	Stud Size	Stud	Length	Width		Pad Thickness	Tube Thickness	Barrel Length	Barrel I.D.	Pad Length	Strip Length
				L	W	F	T	TT	BL	ID		
CL1014TP	1/0	1/4"	0.265"	1.700"	0.753"	0.401"	0.102"	0.0512"	0.560"	0.417"	0.850"	0.550"
CL1056TP		5/16"	0.328"	1.840"	0.769"	0.416"					0.920"	
CL1038TP		3/8"	0.397"	1.870"	0.764"	0.461"	0.096"				0.968"	
CL1012TP		1/2"	0.515"	1.900"	0.756"	0.520"						
CL2014TP	2/0	1/4"	0.265"	1.900"	0.874"	0.440"	0.097"	0.0551"	0.720"	0.460"	0.912"	0.710"
CL2056TP		5/16"	0.328"	1.940"	0.891"	0.441"					0.974"	
CL2038TP		3/8"	0.397"	2.000"	0.837"	0.462"	0.110"					
CL2012TP		1/2"	0.515"			0.522"						
CL3056TP	3/0	5/16"	0.328"	2.200"	0.894"	0.424"	0.114"	0.0591"	0.810"	0.496"	1.035"	0.800"
CL3038TP		3/8"	0.397"			0.526"						
CL3012TP		1/2"	0.515"	0.520"								
CL4056TP	4/0	5/16"	0.328"	2.360"	1.000"	0.514"	0.114"	0.0591"	0.840"	0.551"	1.100"	0.830"
CL4038TP		3/8"	0.397"			0.564"						
CL4012TP		1/2"	0.515"			0.540"						

** All dimensions in inches*

**SPECIFICATIONS OF COPPER CABLE LUGS
(SEAMLESS TUBULAR) (NON-PLATED)
AWG 8 to AWG 1**

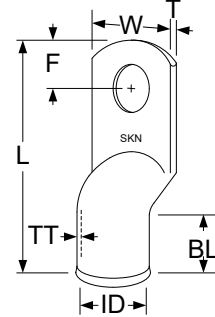

- Maximum voltage is 600V.

Product Number	Wire Range (AWG)	Stud Size	Stud	Length	Width		Pad Thickness	Tube Thickness	Barrel Length	Barrel I.D.	Pad Length	Strip Length
				L	W	F	T	TT	BL	ID		
CL810	8	#10	0.200"	1.100"	0.450"	0.246"	0.048"	0.0354"	0.340"	0.185"	0.624"	0.330"
CL814		1/4"	0.265"	1.200"	0.480"	0.318"	0.049"				0.686"	
CL856		5/16"	0.328"	1.230"	0.510"	0.330"	0.045"				0.724"	
CL838		3/8"	0.407"	1.366"	0.614"		0.055"	0.0512"	0.433"	0.185"	0.443"	
CL812		1/2"	0.512"	1.508"	0.728"		0.051"					
CL610	6	#10	0.200"	1.340"	0.540"	0.254"	0.053"	0.0394"	0.420"	0.232"	0.725"	0.410"
CL614		1/4"	0.265"			0.280"	0.052"				0.751"	
CL656		5/16"	0.328"	1.370"	0.550"	0.364"	0.047"				0.756"	
CL638		3/8"	0.397"	1.380"	0.590"	0.370"	0.047"	0.767"				
CL612		1/2"	0.515"	1.550"	0.740"	0.390"	0.035"	0.905"				
CL410	4	#10	0.200"	1.350"	0.540"	0.300"	0.066"	0.0314"	0.530"	0.299"	0.654"	0.520"
CL414		1/4"	0.265"	1.380"			0.065"				0.677"	
CL456		5/16"	0.328"	1.420"	0.590"	0.350"	0.056"				0.708"	
CL438		3/8"	0.397"	1.560"	0.678"	0.419"	0.060"	0.835"				
CL412		1/2"	0.515"	1.640"	0.740"	0.406"	0.057"	0.898"				
CL214	2	1/4"	0.265"	1.610"	0.626"	0.310"	0.082"	0.0433"	0.550"	0.343"	0.727"	0.540"
CL256		5/16"	0.328"			0.360"	0.086"				0.779"	
CL238		3/8"	0.397"	1.720"	0.689"	0.440"	0.068"				0.839"	
CL212		1/2"	0.515"	1.770"	0.730"	0.481"	0.063"				0.995"	
CL114	1	1/4"	0.265"	1.680"	0.656"	0.401"	0.082"	0.0433"	0.560"	0.360"	0.793"	0.550"
CL156		5/16"	0.328"			0.673"	0.374"				0.083"	
CL138		3/8"	0.397"	1.800"	0.720"	0.421"					0.994"	
CL112		1/2"	0.515"	1.860"	0.800"	0.485"	0.067"				0.984"	

* All dimensions in inches

**SPECIFICATIONS OF COPPER CABLE LUGS
(SEAMLESS TUBULAR) (NON-PLATED)
AWG 1/0 to AWG 4/0**

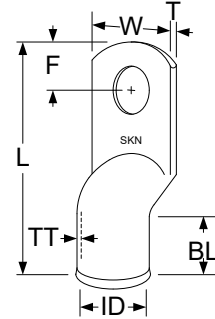

- Maximum voltage is 600V.

Product Number	Wire Range (AWG)	Stud Size	Stud	Length	Width		Pad Thickness	Tube Thickness	Barrel Length	Barrel I.D.	Pad Length	Strip Length
				L	W	F	T	TT	BL	ID		
CL1014	1/0	1/4"	0.265"	1.700"	0.753"	0.401"	0.102"	0.0512"	0.560"	0.417"	0.850"	0.550"
CL1056		5/16"	0.328"	1.840"	0.769"	0.416"					0.920"	
CL1038		3/8"	0.397"	1.870"	0.764"	0.461"	0.096"				0.968"	
CL1012		1/2"	0.515"	1.900"	0.756"	0.520"						
CL2014	2/0	1/4"	0.265"	1.900"	0.874"	0.440"	0.097"	0.0551"	0.720"	0.460"	0.912"	0.710"
CL2056		5/16"	0.328"	1.940"	0.891"	0.441"					0.974"	
CL2038		3/8"	0.397"	2.000"	0.837"	0.462"	0.110"					
CL2012		1/2"	0.515"								0.522"	
CL3056	3/0	5/16"	0.328"	2.200"	0.894"	0.424"	0.114"	0.0591"	0.810"	0.496"	1.035"	0.800"
CL3038		3/8"	0.397"			0.526"						
CL3012		1/2"	0.515"	0.520"								
CL4056	4/0	5/16"	0.328"	2.360"	1.000"	0.514"	0.114"	0.0591"	0.840"	0.551"	1.100"	0.830"
CL4038		3/8"	0.397"			0.564"						
CL4012		1/2"	0.515"			0.540"						

* All dimensions in inches

COPPER CABLE LUGS

RECOMMENDED TOOLS

**RECOMMENDED TOOLS OF COPPER CABLE LUGS
(SEAMLESS TUBULAR)**



**Heavy Duty Handheld
Hexagon Crimper**
Product Number: RC408SKN



Round Cable Cutter
Product Number: 200-046



Heavy Duty Cable Cutter
Product Number: 200-006



Wire Stripper Tool
Product Number: 200-003



Rotary Cable Slitter
Product Number: 200-009

RECOMMENDED TOOLS OF COPPER CABLE LUGS (SEAMLESS TUBULAR)			
Product Number	Crimp Tool	Wire Cutter	Wire Stripper
CL810TP – CL856TP	RC408SKN	200-046	200-003
CL810 – CL856			
ALL OTHER COPPER CABLE LUGS		200-006	200-009



IMPORTANT NOTES FOR PURCHASERS AND USERS

IMPORTANT NOTES FOR PURCHASERS AND USERS

Before using this product, user should determine the suitability of the product for its intended use.

SKN expressly disclaims the implied warranties and conditions of merchantability and fitness for a particular purpose. In no case shall SKN be liable under any legal theory, including but not limited to contract or strict liability, for any direct, indirect, special, incidental, or consequential damages resulting from product use.

Made in China



WARRANTY; LIMITED REMEDY; LIMITED LIABILITY

WARRANTY; LIMITED REMEDY; LIMITED LIABILITY

This product will be free from defects in material and manufacture as the date of purchase. SKN makes no other warranties including, but not limited to, any implied warranty of merchantability or fitness for a particular purpose. If this product is defective within the warranty period stated above, your exclusive remedy shall be, at SKN's option, to replace or repair or refund the purchase price of SKN product. Except where prohibited by Law, SKN will not be liable for any loss or damage arising from SKN product, whether direct, indirect, special, incidental or consequential regardless of the legal theory asserted.